

THE INFORMATION CONTAINED IN THIS DRAWING IS THE SOLE PROPERTY OF INNOVATIVE EQUIPMENT SOLUTIONS. ANY REPRODUCTION IN PART OR WHOLE WITHOUT THE WRITTEN PERMISSION OF INNOVATIVE EQUIPMENT SOLUTIONS IS PROHIBITED.

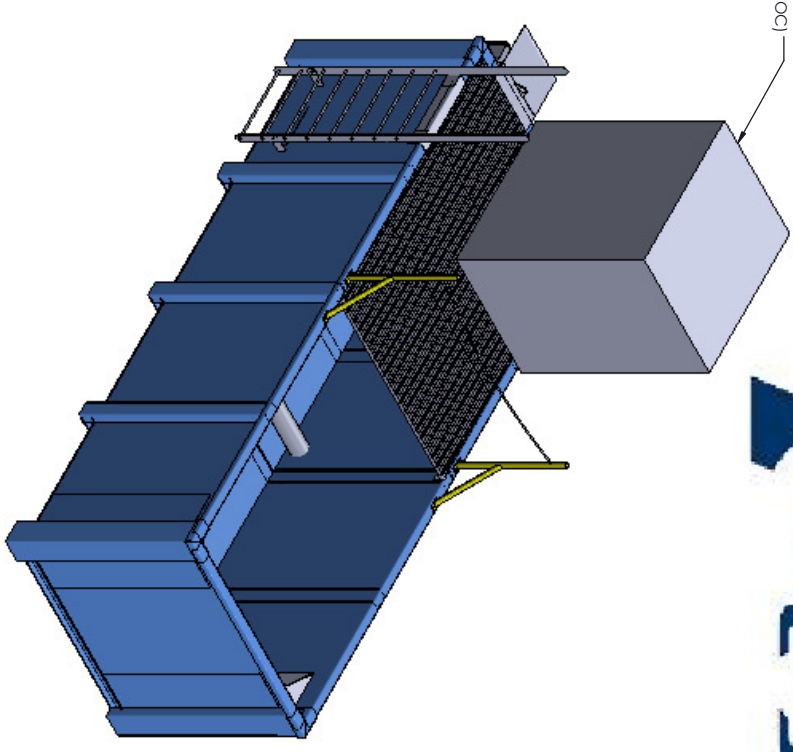

FLOCCULANT DISPENSER VARIES UPON FINAL REVIEW (SHOWN IS WORST CASE SIZE TO EASILY ACCOMMODATE 300-400LB OF DRY FLOCC)

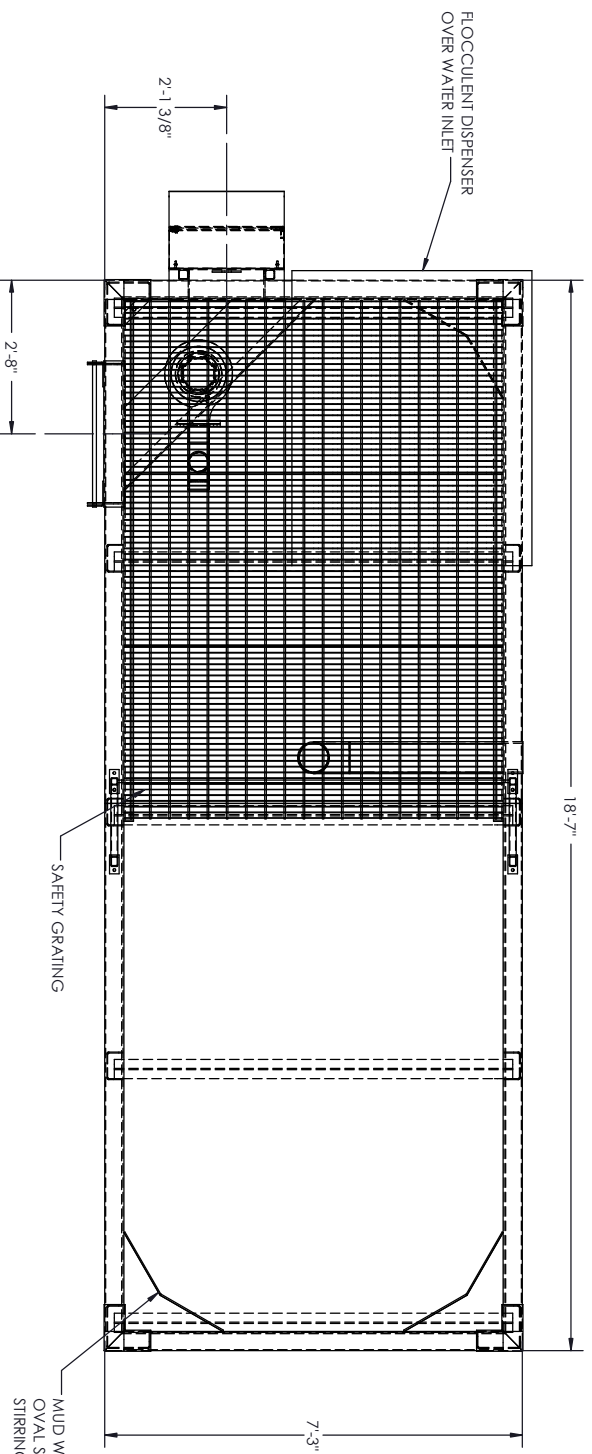
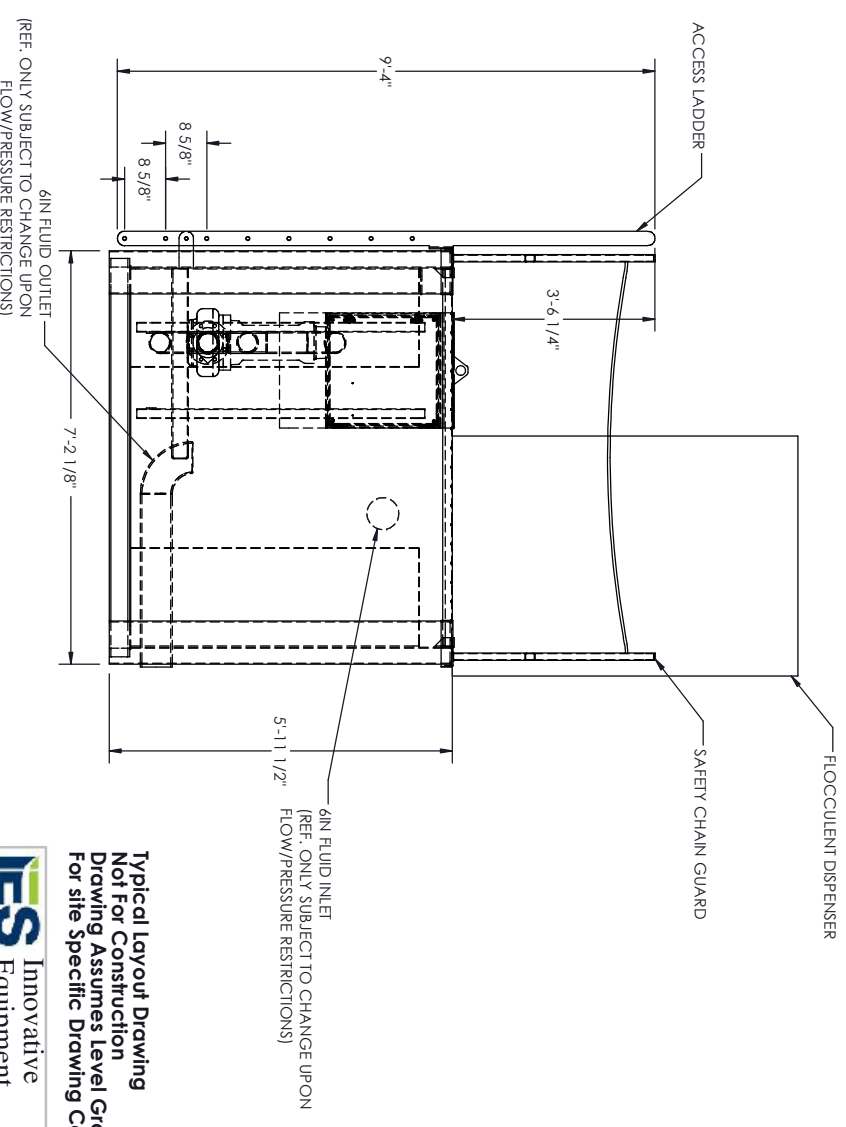
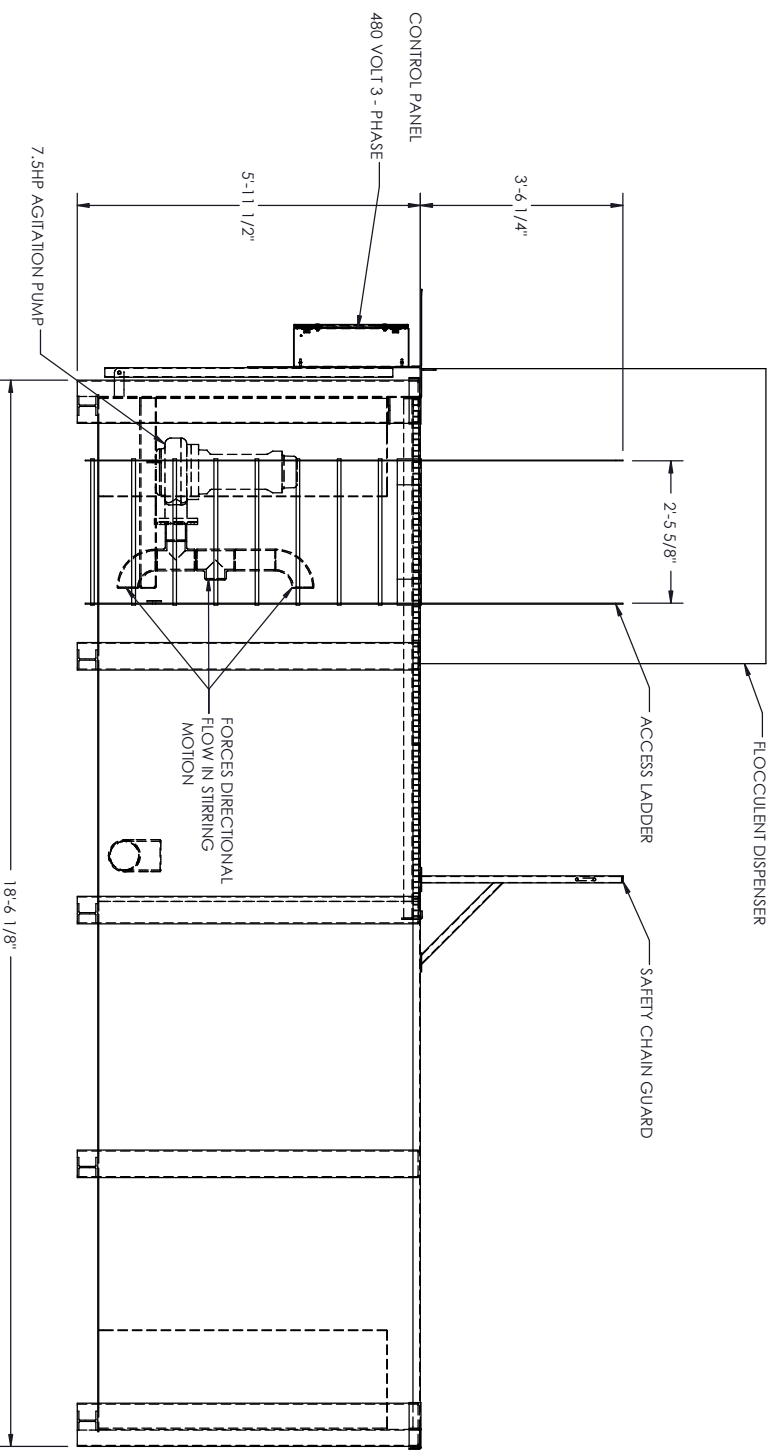

**Typical Layout Drawing  
Not For Construction  
Drawing Assumes Level Ground  
For site Specific Drawing Contact IES**

**IES** Innovative Equipment Solutions  
174 Cornerstone Ct, Suite B  
Hill Spring, TN 37113  
Office: (615) 525-8488  
Toll Free: 1-866-303-4IES  
Fax: (615) 520-5206

REF DWG:	TOOLERANCES (UNLESS NOTED)
	FRACTIONAL : ±1/16"
	DECIMAL 0.00 : ±.02"
	DECIMAL 0.000 : ±.005"
	ANGLED DIM'S : ±.01" @ 90°
	TOOLERANCES FOR THE OVERALL DIMENSIONS ARE NOT GOVERNATIVE
DRAWN BY:	CMT
CHECKED BY:	
DATE:	10/29/2013
SCALE:	1:40
MODEL NAME:	3500 Gallon Floc Whipload Agitator Tank Sub Assembly
SHEET NO.:	8
DWG. NO.:	3500 Gallon Floc Whipload Agitator Tank

